

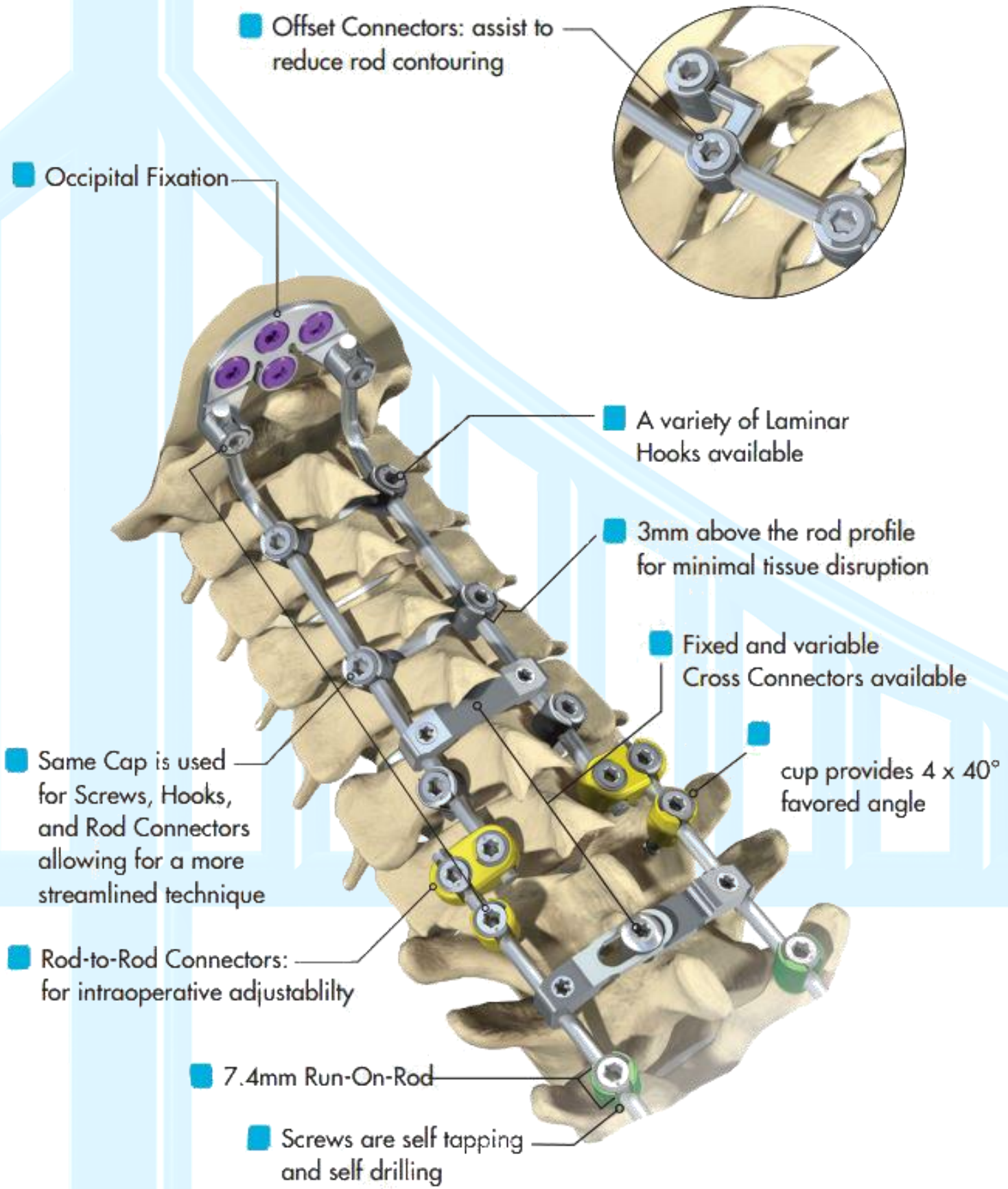

POSTERIOR CERVICAL SYSTEM



PRESIDIO
SURGICAL



Lateral Mass Screws

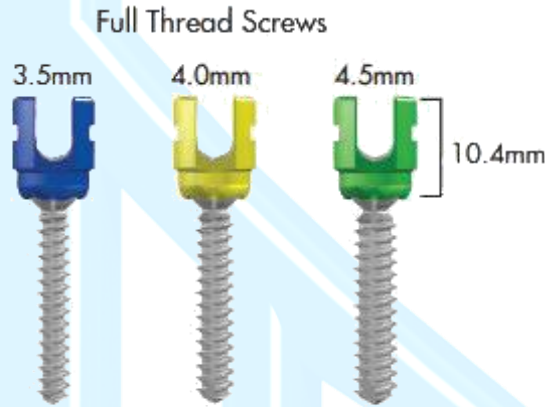

- Conical shape cap provides multiple point fixation to rod
- Wide range of screw diameters and lengths allows for anatomical variation
- Surgeon can attain favored angle at four positions

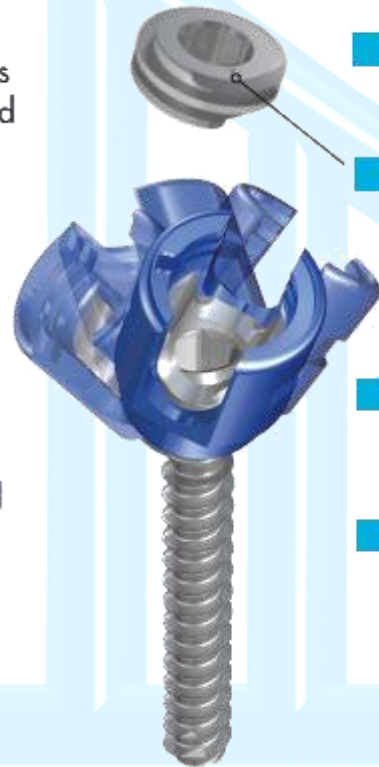

- Low locking torque at 35 inch-pounds
- Recessed marker gives visual identifier of lead-in thread to minimize cross threading
- 4 x 40° favored angle provides up to 80° of polyaxial motion
- Non-favored angle provides up to 62° of polyaxial motion

Occipital Screws



Screw Diameters 4.5 and 5.5mm
6-16mm Lengths

Occipital Plates



Small (24mm)



Medium (30mm)



Large (36mm)

Cervical Hooks

- Hooks available in 4.5mm and 6.0mm widths
- Final lock at 35 inch-pounds

Inline



Offset Right



Offset Left

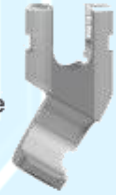

30° angle

Rods

3.5mm Rod



3.5/5.5mm Transitional Rod 400mm length



Pre-Bent Rods Lengths 100-500mm

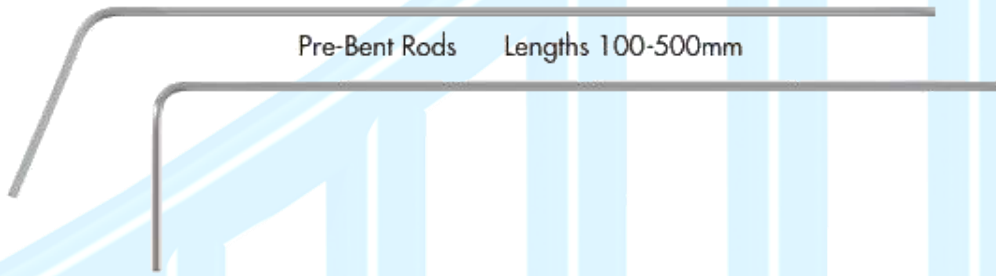

Lengths Available:

- 30-50mm (5mm increments)
- 60-100mm (10mm increments)
- 200mm

Cross Connectors

- Sizing variability

- 3.5mm Rod

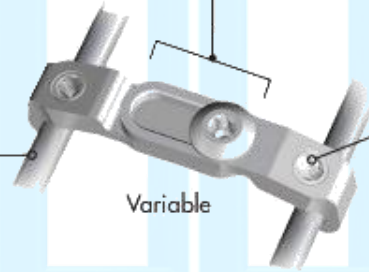

Variable

- Final lock at 35 inch-pounds

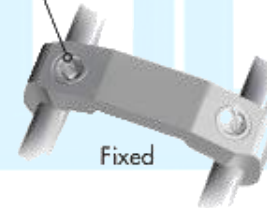

Fixed

Offset and Rod Connectors

Lateral Offset Connector



Left and Right Offset Connectors



Cable Connector



Parallel Connector



Axial/Parallel Connector



Item #	Description
PSX067-0370	3.5mm Rod, 30mm
PSX067-0371	3.5mm Rod, 35mm
PSX067-0372	3.5mm Rod, 40mm
PSX067-0373	3.5mm Rod, 45mm
PSX067-0374	3.5mm Rod, 50mm
PSX067-0376	3.5mm Rod, 60mm
PSX067-0378	3.5mm Rod, 70mm
PSX067-0380	3.5mm Rod, 80mm
PSX067-0382	3.5mm Rod, 90mm
PSX067-0384	3.5mm Rod, 100mm
PSX067-0404	3.5mm Rod, 200mm
PSX067-0020	3.5 X 10mm Screw
PSX067-0021	3.5 X 12mm Screw
PSX067-0022	3.5 X 14mm Screw
PSX067-0023	3.5 X 16mm Screw
PSX067-0024	3.5 X 18mm Screw
PSX067-0025	3.5 X 20mm Screw
PSX067-0026	3.5 X 22mm Screw
PSX067-1500	4.0 X 10mm Screw
PSX067-1501	4.0 X 12mm Screw
PSX067-1502	4.0 X 14mm Screw
PSX067-1503	4.0 X 16mm Screw
PSX067-1504	4.0 X 18mm Screw
PSX067-1505	4.0 X 20mm Screw
PSX067-1506	4.0 X 22mm Screw
PSX067-1507	4.0 X 24mm Screw
PSX067-1508	4.0 X 26mm Screw
PSX067-1509	4.0 X 28mm Screw
PSX067-0045	4.5 X 20mm Screw
PSX067-0047	4.5 X 24mm Screw
PSX067-0049	4.5 X 28mm Screw
PSX067-0051	4.5 X 32mm Screw
PSX067-0053	4.5 X 36mm Screw
PSX067-0055	4.5 X 40mm Screw

Item #	Description
PSX067-0250	3.5X16mm Threaded X8mmX24mm Screw
PSX067-0253	3.5X18mm Threaded X8mmX26mm Screw
PSX067-0257	3.5X20mm Threaded X9mmX29mm Screw
PSX067-0261	3.5X22mm Threaded X9mmX31mm Screw
PSX067-0264	3.5X24mm Threaded X10mmX34mm Screw
PSX067-0267	3.5X26mm Threaded X10mmX36mm Screw
PSX067-1541	4.0X16mm Threaded X11mmX27mm Screw
PSX067-1544	4.0X18mm Threaded X11mmX29mm Screw
PSX067-1548	4.0X20mm Threaded X12mmX32mm Screw
PSX067-1552	4.0X22mm Threaded X12mmX34mm Screw
PSX067-1555	4.0X24mm Threaded X13mmX37mm Screw
PSX067-1558	4.0X26mm Threaded X13mmX39mm Screw
PSX067-0368	3.5 - 5.5mm Transitional Rod, 400mm
PSX067-1700	Lamina Hook, Inline, 4.5mm
PSX067-1701	Lamina Hook, Inline, 6.0mm
PSX067-1710	Lamina Hook, Offset Right, 4.5mm
PSX067-1711	Lamina Hook, Offset Right, 6.0mm
PSX067-1720	Lamina Hook, Offset Left, 4.5mm
PSX067-1721	Lamina Hook, Offset Left, 6.0mm
PSX067-0130	Cross Connector, 28-33mm
PSX067-0131	Cross Connector, 33-42mm
PSX067-0132	Cross Connector, 42-58mm
PSX067-0150	Fixed Cross Connector, 22mm
PSX067-0151	Fixed Cross Connector, 24mm
PSX067-0152	Fixed Cross Connector, 26mm
PSX067-0105	Tiger Locking Cap



Presidio Surgical, Inc.
1451 Danville Blvd. Suite 204
Alamo, CA 94507

PHONE: (916)941-1967
FAX: (925)217-4821
www.presidiosurgicalspine.com

INDICATIONS: See Package Insert for a more complete listing of indications, contraindications, warnings, precautions, and other important information.

WARNING: In the USA, this product has labeling limitations. See package insert for complete information.

CAUTION: Federal Law (USA) restricts this device to sale by or on the order of a physician.

Products Patented and Patents Pending

All products are not currently available in all markets